

PSM 280



YARI OTOMATİK TESTERE TEZGAHI SEMI AUTOMATIC BANDSAW MACHINE



ÖLÇÜLER DIMENSIONS

MAFSALLI MODELLER PIVOT TYPES

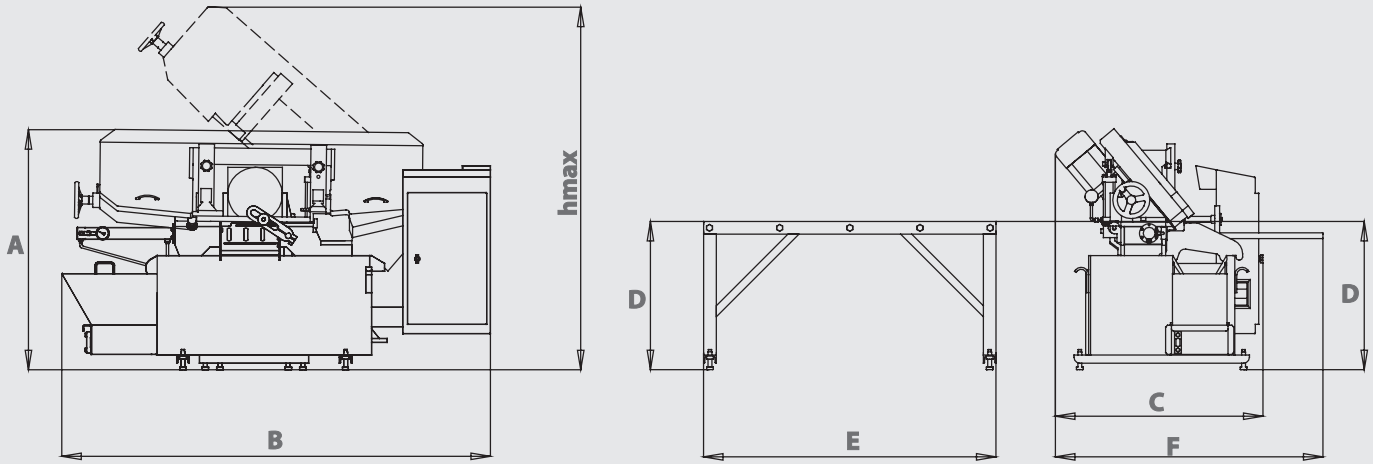

TEKNİK ÖZELLİKLER TECHNICAL FEATURES

A	1235 mm 48.62 inch	B	2200 mm 86.61 inch	C	1065 mm 41.93 inch	D	725 mm 28.54 inch	E	1500 mm 59.06 inch	F	1375 mm 54.13 inch	hmax	1880 mm 74.02 inch
---	-----------------------	---	-----------------------	---	-----------------------	---	----------------------	---	-----------------------	---	-----------------------	------	-----------------------

Yarı Otomatik Semi Automatic	Şerit Ölçüsü Blade Dimension 27 x 0.9 x 3670 mm 1 x 0.035 x 144.5 inch	Şerit Motoru Blade Motor 1,5 kW - 1500 d/dk 2 hp - 1500 rpm	Sürücü Motor Feeding Motor Manuel Manual
Hidrolik Motor Hydraulic Pump Motor 0.75 kW - 1400 d/dk 1 hp - 1400 rpm	Soğutucu Motor Cooling Liquid Motor 0.12 kW - 3000 d/dk 0.16 hp - 3000 rpm	Voltaj Voltage 400 V 400 V	Maksimum Güç Maximum Power 2,37 kW 3,17 hp
Kesme Hızı Cutting Speed 15 m/dk - 49 ft/min 130 m/dk - 426 ft/min	Ağırlık Weight 662 kg 1459 lbs	Malzeme Sıkma Sistemi Material Clamping System Hidrolik Hydraulic	Şerit Germe Sistemi Blade Tensioning System Hidromekanik Hydramechanic

90°	60°	45°	30°	0°	106°	45°	60°
Kesim Kapasitesi Cutting Capacity	Kesim Kapasitesi Cutting Capacity	mm inch	250 mm 9.84 inch	280 mm 11.02 inch	280 mm 11.02 inch	250 x 250 mm 9.84 x 9.84 inch	140 x 300 mm 5.51 x 11.81 inch
280 mm 7.87 inch	300 mm 11.81 inch	● ■ ■	210 x 210 mm 8.27 x 8.27 inch	280 x 280 mm 11.02 x 11.02 inch	280 x 280 mm 11.02 x 11.02 inch		
			200 x 220 mm 7.87 x 8.66 inch	280 x 280 mm 11.02 x 11.02 inch	140 x 300 mm 5.51 x 11.81 inch		