



# P 16, P 20

Tube-to-tube-sheet orbital weld heads. Designed to enable the welding of boiler tubes fitted to tube sheets in heat exchangers with highest precision and reproducible quality.

Together with the **ORBIMAT CA or CB-range** of orbital welding power sources you will get a state-of-the-art welding system with multiple choices but still easy operation. The rotation of the torch is consistent and the delivery of the welding current is also kept constant and can be varied around the circumference of the tube.

## Features:

- Easy and safe handling with most functionality
- The water cooling leads up to the TIG torch
- Up to 30° continuous swivelling TIG torch (by reduced diameter)
- The positioning at the tube to be welded is carried out by a mandrel which has to be plugged on a locator arm

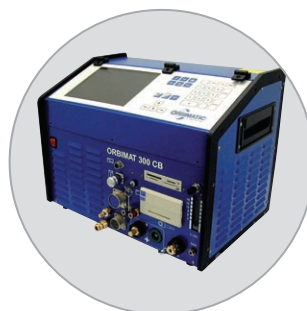

❖ *Compact computer controlled orbital welding power source ORBIMAT 300 CB*



❖ *Mandrels*

Our tube-to-tube-sheet orbital weld heads are available in 3 different versions (for other dimensions on request):

Model	from tube-ID	up to tube-OD	Code
P 16 Tube-to-tube-sheet orbital weld head with cold-wire feeding	10 mm	78 mm	831 000 001
P 20 Tube-to-tube-sheet orbital weld head with cold-wire feeding	10 mm	70 mm	832 000 002
P 20 Tube-to-tube-sheet orbital weld head without cold-wire feeding	10 mm	70 mm	832 000 001



# P 16 and P 20 tube-to-tube-sheet orbital weld heads

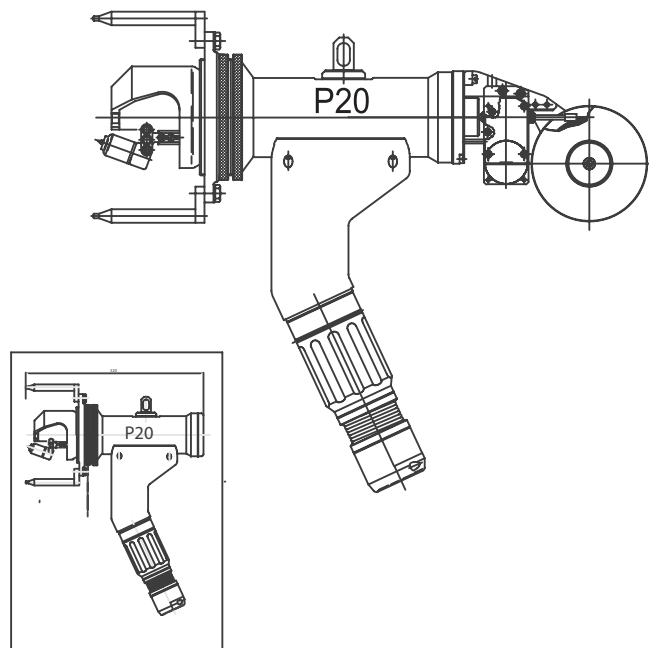
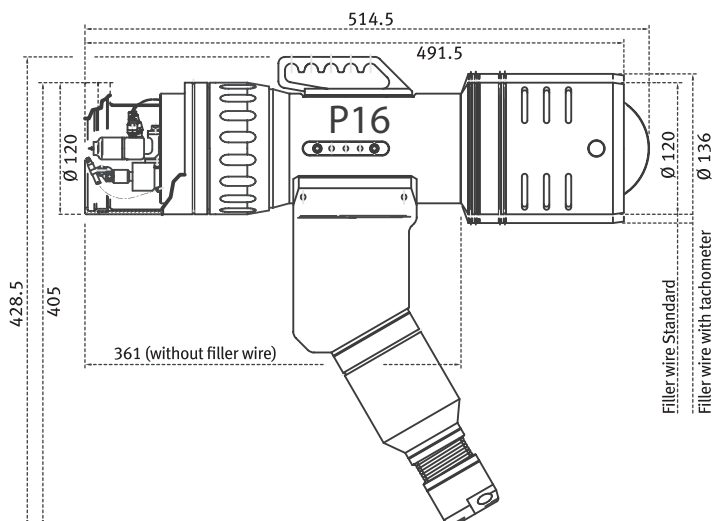

P 20 and P 16 are equipped with a cold-wired feeding and a retainer for a 100 mm standard wire spool which are directly mounted to the welding head.

The P16 is additionally equipped with the following features:

- Complete water-cooled weld head housing.
- The wire-feeding moves along the axis of the TIG torch to prevent distortion of the auxiliary wire while leaving the wire duct

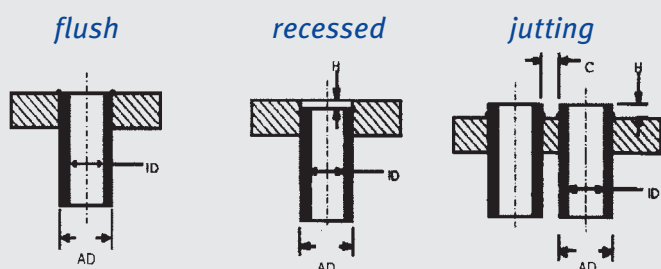

Furthermore all weld heads are fitted with a swivel coupling for water and gas as well as a locator arm for mandrels of group A, a cold-wired feeding and a three point support system.

The length of the cable is 7.5 m (24.6 ft).

## Accessories

## Code

Ground cable for 165 A, length: 5 m (16.4 ft)	<b>811 050 004</b>
Ground cable for 300 A, length: 5 m (16.4 ft)	<b>811 050 005</b>
Balancer for load-free hanging of P16/P20	<b>832 020 001</b>
Double gas-chamber for Titanium tubes (P16)	<b>831 020 101</b>
Double gas-chamber for Titanium tubes (P20)	<b>832 020 002</b>
Mandrels and locator arms for different dimensions	<b>on request</b>
Front cage for P 16	<b>831 050 001</b>

## Technical data

## P 16

## P 20

Weight with cold-wired feeding unit	10 kg	6 kg
Weight without cold-wired feeding unit	8 kg	5 kg

*The technical data are not binding. They are not warranted characteristics and are subject to change. Please consult our general conditions of supply.*

Stamp of distributor:

© Orbitalum Tools GmbH (09.2009)



## Orbitalum Tools GmbH

### Sales and Consulting:

Tel. +49 (0) 77 31 792-786 up to -789  
Fax +49 (0) 77 31 792-524  
tools@orbitalum.com  
www.orbimatic.com

### Plant:

Division Orbimatic  
Floesser Weg 17  
35418 Buseck  
Germany